

DOROTHEA

Sofa, Sofa SYSTEM,

Andrea Steidl,
2023

laCividina

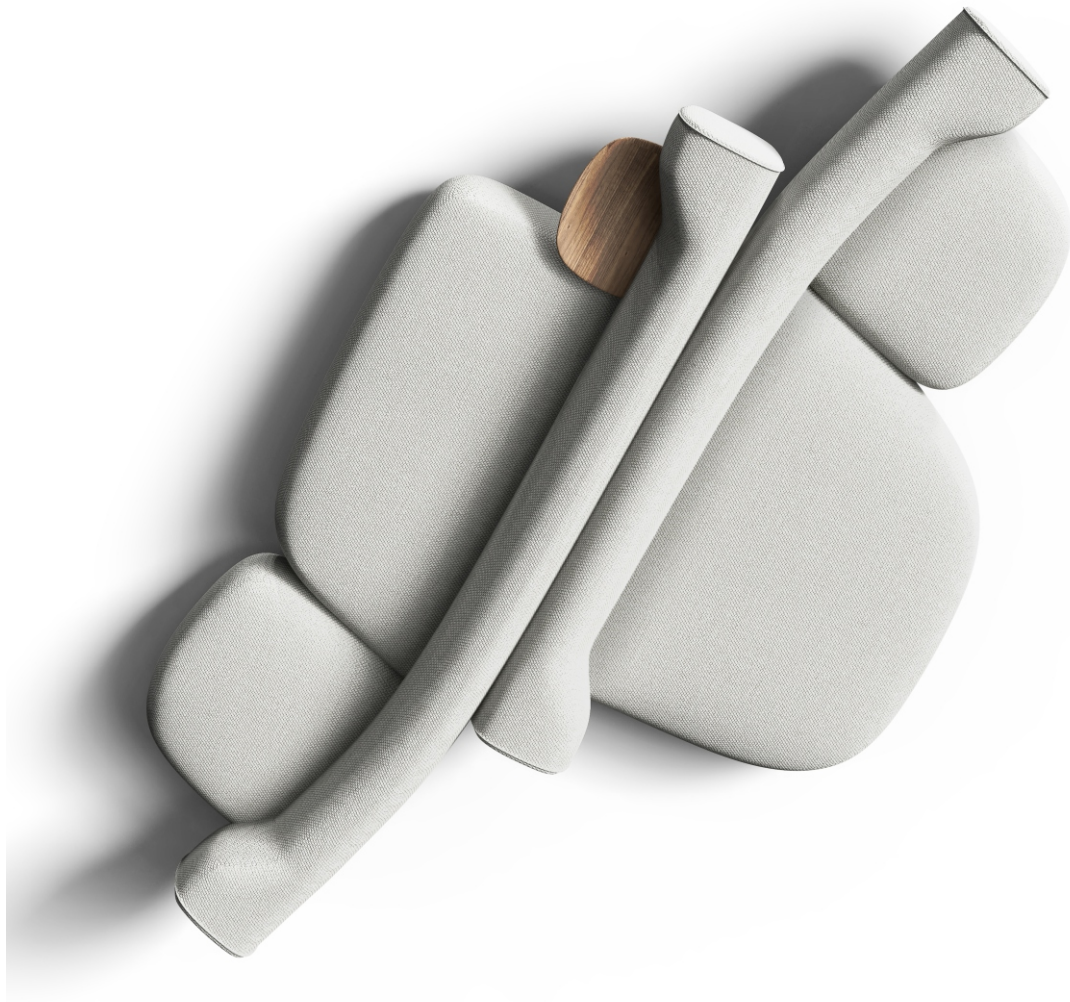

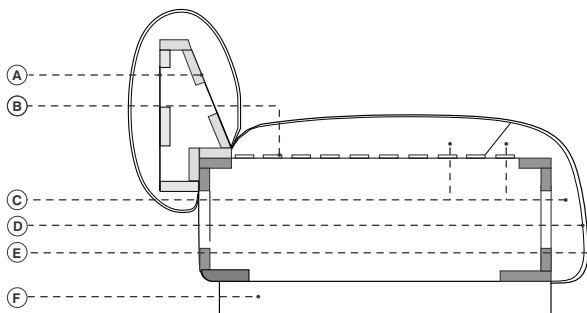

■ Legno massiccio di abete	■ Solid fir	■ Bois de sapin massif	■ Massivholz aus Tanne
■ Legno massiccio di faggio	■ Solid beech	■ Bois de hêtre massif	■ Massivholz aus Buche
A. Pannello di masonite	A. Masonite panels	A. Panneau de particules	A. Holzfaserplatte
B. Cinghie elastiche ad alta densità	B. High density elastic straps	B. Sangles élastiques	B. Elastischen Gurtbändern
C. Poliuretano espanso ignifugo indeformabile a quote differenziate	C. Flame-retardant undeformable polyurethane foam of different densities	C. Mousse polyuréthane expansé ignifuge indeformable à épaisseurs différenciées	C. Feuerfester formbeständige Polyurethanschaum in unterschiedlicher Dichte
D. Fibra di poliestere	D. Polyester fibers	D. Fibre de polyester	D. Polyester
E. Rivestimento	E. Upholstery	E. Revêtement	E. Beschichtung
F. Legno di frassino	F. Ash wood	F. Bois de frêne	F. Eschenholz

**NOTE
NOTES
ANNOTATION
ANMERKUNG**

■ Su richiesta attacco per connessione elettrica e USB con sovrapprezzo	■ Electrical connection and USB upon request with upcharge	■ Sur demande connection électrique et USB avec surcoût	■ Elektrische Verbindung und USB-Anschluss auf Anfrage gegen Aufpreis
■ Cuscini extra	■ Extra cushions	■ Autres coussins	■ Weitere Kissen
■ COM: tessuto cliente (tinta unita e h.140 cm.) - campione richiesto	■ COM: client's fabric (plain colour and width 140 cm.) - sample required	■ COM: tissu fourni (couleur unie et hauteur 140 cm.) - échantillon nécessaire	■ COM: Kundenstoff (einfarbig und Breite 140 cm.) - Stoffmuster nötig
■ COL: pelle cliente - campione richiesto	■ COL: client's leather - sample required	■ COL: cuir fourni - échantillon nécessaire	■ COL: Kundenleder - Ledermuster nötig

**FINITURA PIEDI
LEGS FINISHES
FINITIONS DE PIEDS
FÜSSE AUSFÜHRUNGEN**



Frassino naturale
Natural ash
Frêne naturel
Eschenholz Naturfarbe



Frassino tinto grafite
Graphite-stained ash
Frêne teinté graphite
Eschenholz Graphit gebeizt

**OPZIONE
OPTION
OPTION
OPZION**



Su richiesta attacco per connessione elettrica e USB con sovrapprezzo
Electrical connection and USB upon request with upcharge
Sur demande connection électrique et USB avec surcoût
Elektrische Verbindung und USB-Anschluss auf Anfrage gegen Aufpreis

**RIVESTIMENTI CONSIGLIATI
RECOMMENDED COVERINGS
REVÊTEMENTS CONSEILLÉS
EMPFOHLENE BEZÜGE**

CAT. START
RINGO
OPUS

CAT. A
XTREME
TAILOR
ANGEL
MEDLEY
SAMAR
AVON
MAGNUM
AUTUMN
HANGO

CAT. B
FAME
MAIN LINE FLAX
HESTAN
SILVERTEX
GEIKO

CAT. C
SUPERB
TREND
KEN BI
MIKONOS
ANDROS

CAT. SUPER
ORSETTO
REMIX 3
MYLLA
TWISTED FLOWER
DHARMA DIS.400
DHARMA DIS.200
DHARMA DIS.600
DHARMA DIS.100
DHARMA DIS.500
DIVA DIS.01

CAT. EXTRA
STEELCUT TRIO 3
ARIANA
OPERA
ARCO
CREDO
TRIO
BIT
DIVA DIS.05
DIVA DIS.21
DIVA DIS.29

CAT.MAXI
UNIFORM MÉLANGE
HALLINGDAL 65
DIVINA 3

CAT. TOP
ARDA
REGOS

CAT. SPECIAL
GENTLE 2

CAT. LUX
LUX 1
LUX 2

CAT. IMPERIAL
IMPERIAL 1
IMPERIAL 2

DOR01
COMPOSITION

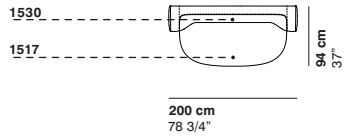

DOR02
COMPOSITION

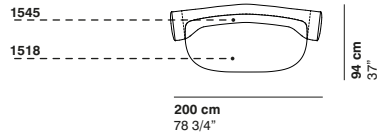

DOR03
COMPOSITION

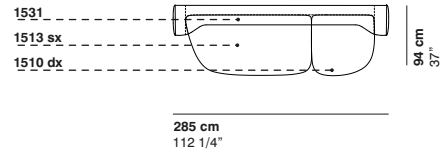

DOR04
COMPOSITION

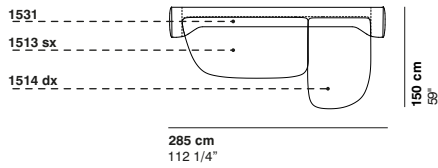

DOR05
COMPOSITION

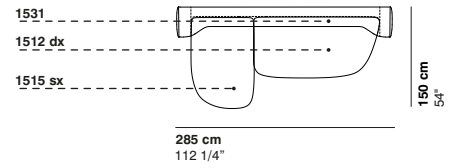

DOR06
COMPOSITION

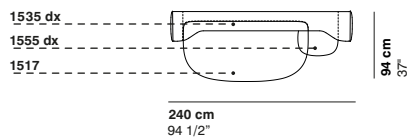

DOR07
COMPOSITION

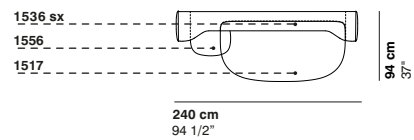

DOR08
COMPOSITION

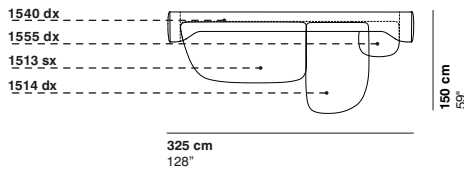

DOR09
COMPOSITION

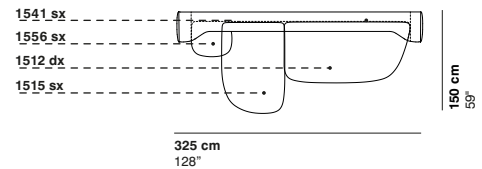

DOR10
COMPOSITION

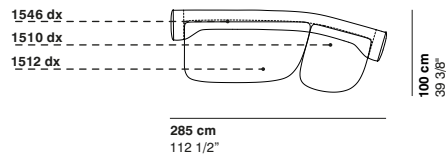

DOR11
COMPOSITION

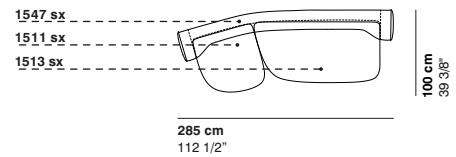

DOR12
COMPOSITION

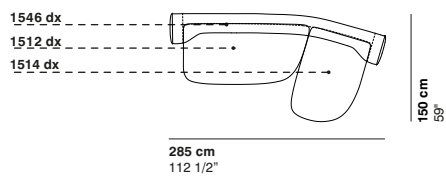

DOR13
COMPOSITION

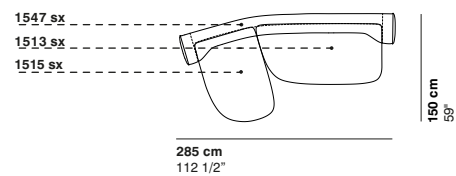

DOR14
COMPOSITION

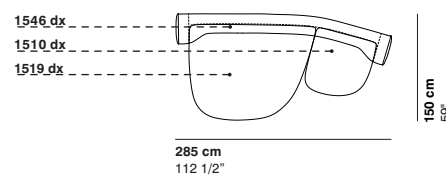

DOR15
COMPOSITION

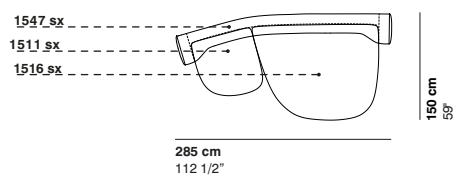

DOR16
COMPOSITION

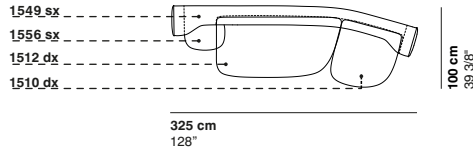

DOR17
COMPOSITION

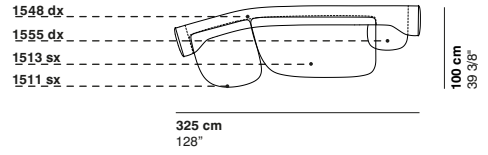

DOR18
COMPOSITION

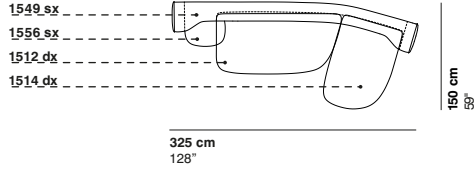

DOR19
COMPOSITION

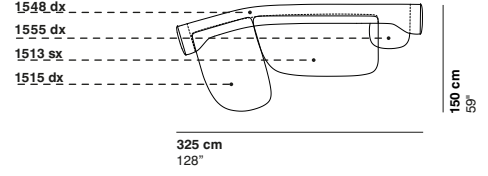

DOR20
COMPOSITION

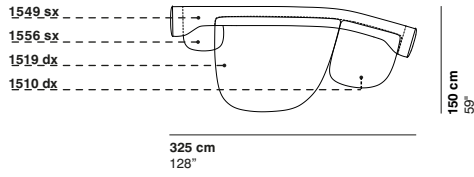

DOR21
COMPOSITION

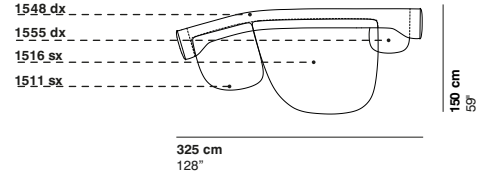

La Cividina s.r.l., al fine di migliorare le caratteristiche tecniche e qualitative della sua produzione, si riserva di apportare, anche senza preavviso, tutte le modifiche che si rendessero necessarie.

With a view to improving the technical characteristics and quality of its products la Cividina s.r.l. reserves the right to develop its products at anytime without notice.

A fin d'améliorer les caractéristiques de sa production, La Cividina s.r.l. se réserve d'apporter, même sans préavis, toutes les modifications qui se rendent nécessaires.

Zur Verbesserung, der technischen und qualitativen Merkmale, behält sich La Cividina s.r.l. vor, alle notwending erscheinenden Produktionsänderungen, auch ohne Vorankündigung durchzuführen.

LA CIVIDINA S.R.L.

HEADQUARTERS / PRODUCTION

Via Spilimbergo 162
33035 Martignacco
Udine Italy
T +39 0432 677433
F +39 0432 677480
info@lacividina.com
lacividina.com

ISO 9001



SHOWROOM MARTIGNACCO

Via Lungolavia 1
33035 Martignacco
Udine Italy
T +39 0432 677433

SHOWROOM MILANO

Palazzo Borromeo
Via Manzoni 41
20121 Milano
Italy
T +39 345 8350810